

尼龍浪管

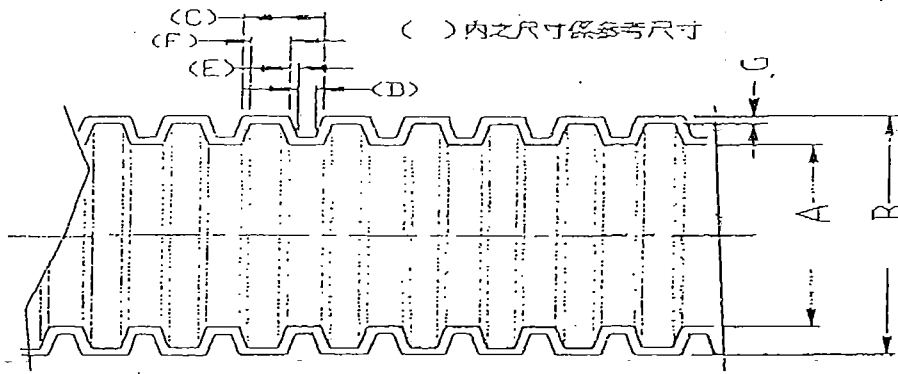

CP系列：For power cabling 電工器材適用(歐系)

Unit : mm

Type 產品型號	CP-07	CP-09	CP-11	CP-16	CP-21	CP-29	CP-36	CP-48
Nominal Dimension 規格	1/4"	5/16"	3/8"	1/2"	3/4"	1"	1 1/4"	2"
A(I.D.)內徑	6.80	9.60	12.00	16.20	21.90	27.60	36.00	47.00
B(O.D.)外徑	10.00	13.00	15.80	21.20	28.50	34.50	42.50	54.50
(C)	2.72	2.93	3.18	3.46	4.76	4.76	6.35	6.35
(D)	0.60	0.60	0.70	0.61	0.75	0.85	1.15	1.10
(E)	0.30	0.30	0.30	0.40	0.50	0.60	0.75	0.75
(F)	1.52	1.73	1.88	2.05	3.01	2.71	3.70	3.75
G	0.35±0.1	0.35±0.1	0.45±0.1	0.45±0.1	0.6±0.1	0.6±0.1	0.75±0.1	0.75±0.1
Length 包裝 Per Pack(卷)	100M	100M			50M		25M	
Material 材質	PA6 UL-94 FR-V2 Thermal distortion temperature 熱變形溫度：+170°C Cold resistances 抗寒溫度：-30°C Fluid resistance 抗化學性 (燃料油(汽油、柴油)、潤滑油、清洗劑、電池酸液)							
Color 顏色	Black 黑							
Remark 備註	() Reference 參考值							

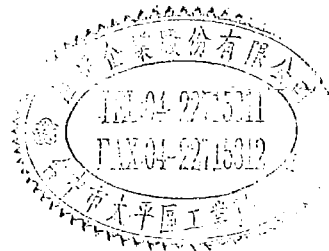

2002/5/17

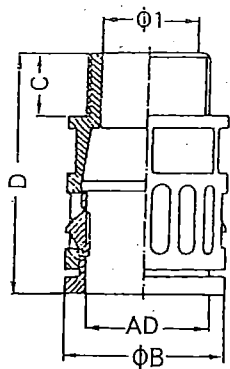

- ◎ 材料: 尼龙
- ◎ 温度范围: - 30度 ~ +100度
- ◎ 颜色: 灰色(黑色)
- ◎ 优点: 只需插入快速安装, 装卸无需任何工具节约30%工作时间。能达到最大牢固程度。
- ◎ 防护等级: IP66

Material: Nylon
 Temperature: From - 30°C ~ +100°C
 Color: Black & Gray
 Features: It is very to fix without any other tools, saving 30% working time and reach the most firm degree.
 Protective: IP66

尼龍浪管快速接頭
(直)

技术参数(Parameter)

SQG-PG

AD	PG	ΦI	ΦB	C	D	Packet
10	7	7	17.0	10	32.5	100
13	7	7	20	10	32.5	100
13	9	7	20	10	32.5	100
13	11	7	20	10	32.5	100
13	13.5	7	20	10	32.5	100
15.8	11	12.5	23.0	10	37.0	100
15.8	13.5	12.5	23.0	10	37.0	100
18.5	13.5	13.5	25.5	11	40.0	50
21.2	13.5	15.4	29.5	12	43.5	50
21.2	16	15.4	29.5	12	43.5	50
28.5	21	23.5	37.0	12	46.0	25
34.5	29	30.0	44.0	12	48.5	20
42.5	36	36.5	51.5	11.5	50.5	10
54.5	48	48.0	65.5	14.5	54.0	5

SQG-N

AD	N	ΦI	ΦB	C	D	Casing
15.8	1/2	12.5	23	12	39	100
21.2	1/2	17	29.5	12	43.5	50
28.5	3/4	21.0	37.0	14.0	47.5	25
34.5	1	27.5	44.0	16.0	52.0	20

技术参数(Parameter)

SQG-M

AD	M	ΦI	ΦB	C	D	Packet
10	10x1.0	7	17.0	10	32.5	100
10	12x1.5	7	17.0	10	32.5	100
10	16x1.5	7	17.0	10	32.5	100
13	12x1.5	7	20	10	32.5	100
13	16x1.5	7	20	10	32.5	100
13	18x1.5	7	20	10	32.5	100
15.8	16x1.5	12.5	23.0	10	37.0	100
15.8	18x1.5	12.5	23.0	10	37.0	100
15.8	20x1.5	12.5	23.0	10	37.0	100
18.5	18x1.5	13.5	25.5	11	40.0	50
18.5	20x1.5	13.5	25.5	11	40.0	50
21.2	20x1.5	15.4	29.5	12	43.5	50
21.2	24x1.5	15.4	29.5	12	43.5	50
28.5	25x1.5	23.5	37.0	12	46.0	25
28.5	27x1.5	23.5	37.0	12	46.0	25
28.5	30x2	23.5	37.0	12	46.0	25
28.5	32x1.5	23.5	37.0	12	46.0	25
34.5	32x1.5	30.0	44.0	12	48.0	20
34.5	33x1.5	30.0	44.0	12	48.0	20
34.5	36x2	30.0	44.0	12	48.0	20
42.5	40x1.5	36.5	51.5	11.5	50.0	10
42.5	42x1.5	36.5	51.5	11.5	50.0	10
42.5	48x2	36.5	51.5	11.5	50.0	10
54.5	63x1.5	48.0	65.5	14.5	54.0	5
54.5	64x2	48.0	65.5	14.5	54.0	5

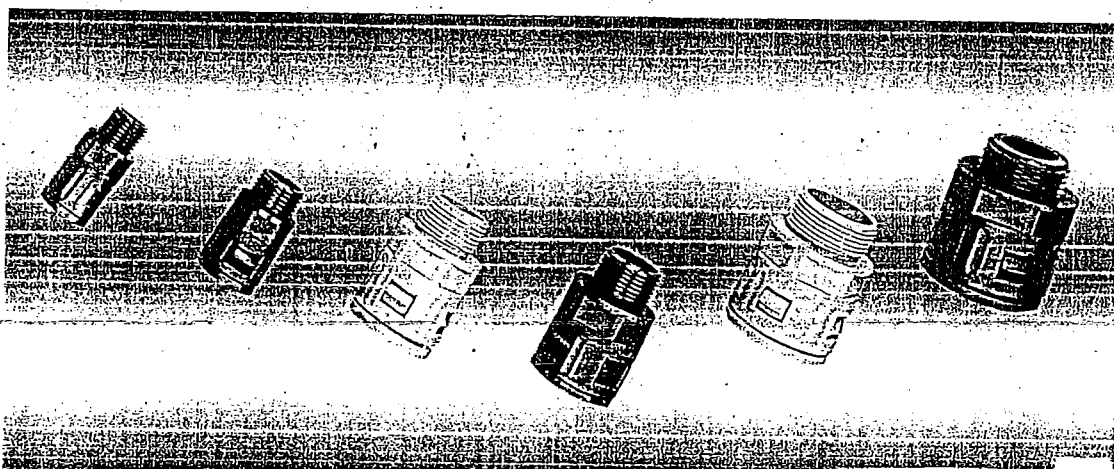

尼龙浪管快速接头(弯)

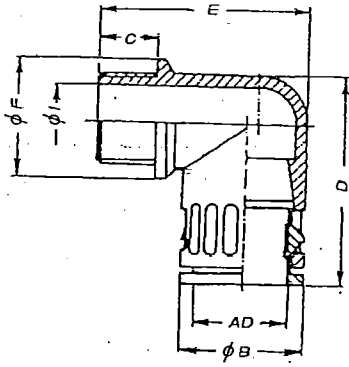

- 材质: 尼龙
- 温度范围: -30 度 ~ +100 度
- 颜色: 灰色 黑色
- 防护等级: IP66
- Material: Nylon
- Temperature: -30°C ~ +100°C
- Color: Black & Gray
- Protective: IP66
- CE 认证

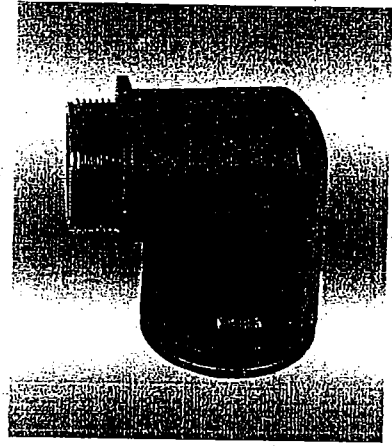

技术参数(Parameter)

SQW-P

AD	PG	Φ I	Φ B	C	D	E	Φ F	Packet
10	7	8.5	17	10	33.5	32.0	16	100
13	9	12	20.0	10	36.0	34.0	20.0	100
15.8	11	15.5	23.0	10	42.0	37.5	23.0	50
18.5	13.5	13.5	26.5	11	46.0	44.0	27.0	50
21.2	16	18	29.5	12	50.0	47.0	27.0	25
28.5	21	24.0	37.0	12	57.0	55.0	34.0	25
34.5	29	32.0	44.0	12	67.5	63.0	43.0	10
42.5	36	36.5	52.0	12	83.0	70.0	52.0	5
54.5	48	48.5	64.0	14	88.0	83.0	65.0	5

技术参数(Parameter)

SQW-M

AD	M	Φ I	Φ B	C	D	E	Φ F	Packet
10	10x1.0	8.0	17	10	33.5	32.0	16	100
10	12x1.5	8.5	17	10	33.5	32.0	16	100
13	16x1.5	12.0	20.0	10	36.0	34.0	23	100
15.8	16x1.5	12.0	23.0	10	42.0	37.5	23	500
15.8	18x1.5	14.5	23.0	10	42.0	37.5	23	500
15.8	20x1.5	15.5	23.0	10	42.0	37.5	23	50
18.5	20x1.5	13.5	26.5	11	46.0	44.0	27	50
21.2	16x1.5	12	29.5	13	50.0	49.0	27	25
21.2	20x1.5	14.8	29.5	13	50.0	49.0	27	25
21.2	25x1.5	14.8	29.5	13	50.0	49.0	27	25
28.5	25x1.5	18	29	13	50.0	49.0	29.5	20
34.5	32x1.5	24.0	44.0	15	67.5	67.0	43.0	10
42.5	40x1.5	32.0	52.0	15	83.0	74.5	52.0	5
54.5	63x1.5	48.5	64.0	14	88.0	83.0	65.0	5

